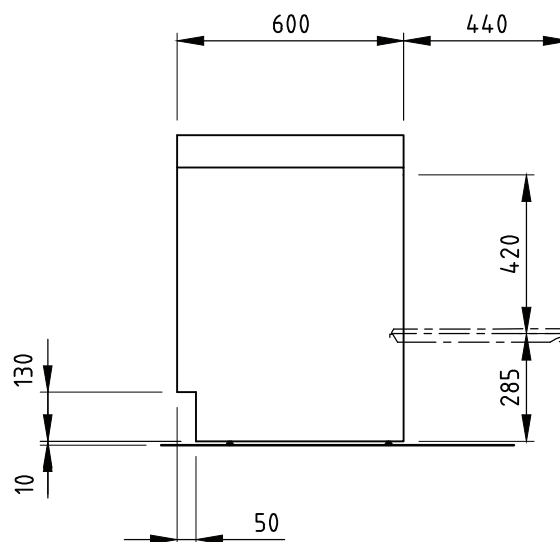
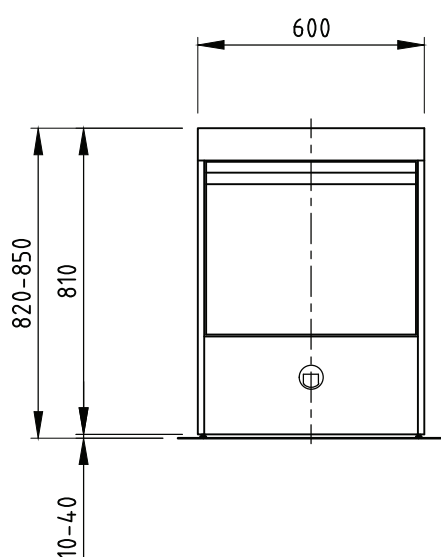

Dimensions UPster® U 500

- Drain connection hose DN 22
- Fresh water feed pipe G 3/4"
- Soft water 10 °C – max. 0.54 mmol/l CaCO₃ (max. 3 °dH)

- Minimum flow pressure: 60 kPa / 0.6 bar – maximum: 500 kPa / 5 bar
- Connecting hose(s) extending approx. 1.6 m from the machine
- Connecting hose can be positioned to the left or right

Technical data:	U 500		Key selling points:
	230 V	400 V	
Tank heating in kW:	2.0		<ul style="list-style-type: none">• Entry height 420 mm• Proven standards of hygiene thanks to digital display of wash and final rinse temperatures• Wash water filter system <i>AktivPlus</i> for brilliant rinsing results thanks to double-filtered fresh water• Exceptionally user-friendly – smart electronic control system with clearly designed icons• Intuitive user interface – blue operating concept• Wash and rinse system at top and bottom, stainless steel wash and rinse arms• Stainless steel detergent and rinse aid pipes inside machine• Pressure booster pump and drain pump• Leakage detection system in the base drip tray• Self-cleaning programme• Stainless steel tank cover sieve• Wash pump with glass protecting soft start• Double walled construction with additional door insulation – reduces heat and noise emissions• Deep-drawn wash chamber with integrated rack guides• Rear cladding made of stainless steel• Complete connection kit for water, waste water and electricity• 400 V or 230 V – can be converted on site• Easy service access
Boiler heating in kW: Fuse 16 A	2.0	6.0	
Pump output in kW:	0.55		
Total connected load in kW: Fuse 16 A	2.9	6.9	
Water consumption in l/rack:	2.6		
Tank capacity in l:	11.0		
Entry height in mm:	420		
Rack size in mm:	500 x 500		
Cycle time in seconds:	160/240/360	90/120/240	
Theoretical capacity racks/h:	22/15/10	40/30/15	
Theoretical capacity plates/h:	396/270/180	720/540/270	
Theoretical capacity glasses/h:	792/540/360	1,440/1,080/540	
If the machine is connected to a cold water supply and/or if racks are inserted in quick succession, the duration of the wash cycles may be increased to achieve hygienic final rinse temperatures.			